

Cooling shroud installation



Before installing the cooling shroud, remove the sparkplug.



Improper installation of the cooling shroud can lead to serious hazards due to the loss of components during flight.



Clean and degrease the threads of the 4 stud bolts M5x30 (1) (recommended Loxeal cleaner 10/Loctite 7063).

Insert the 4 stud bolts M5x30 (1) with thread locker (recommended Loxeal 83-55/Loctite 270) and tighten with the torque shown in the figure.

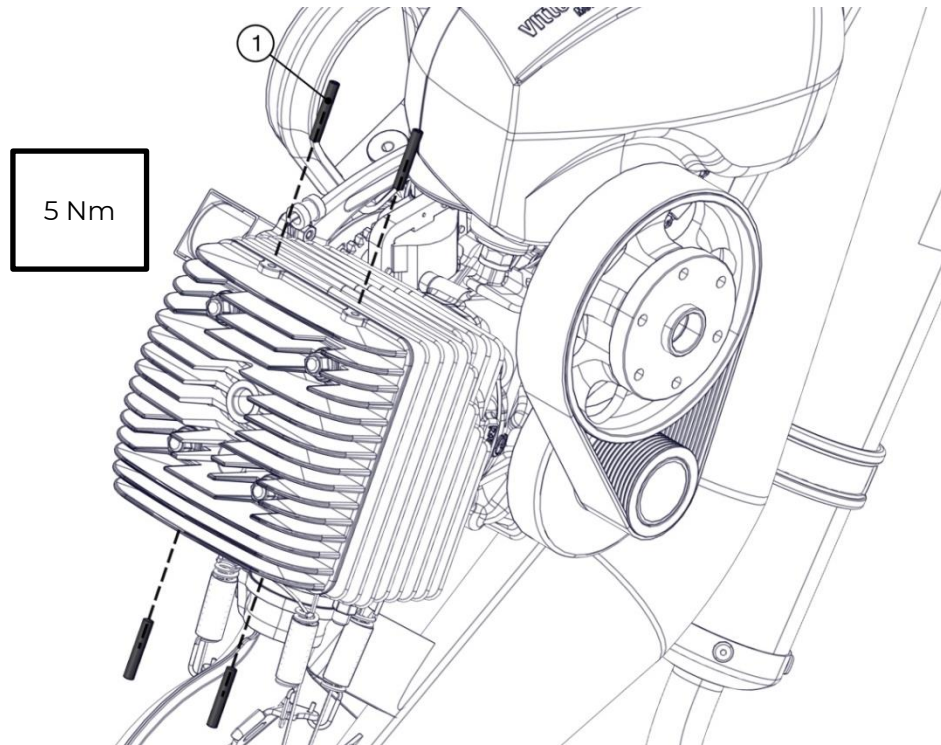



Check that the protrusion of the 4 stud bolts M5x30 (1) is greater than or equal to 17,80 mm, otherwise use longer stud bolts.

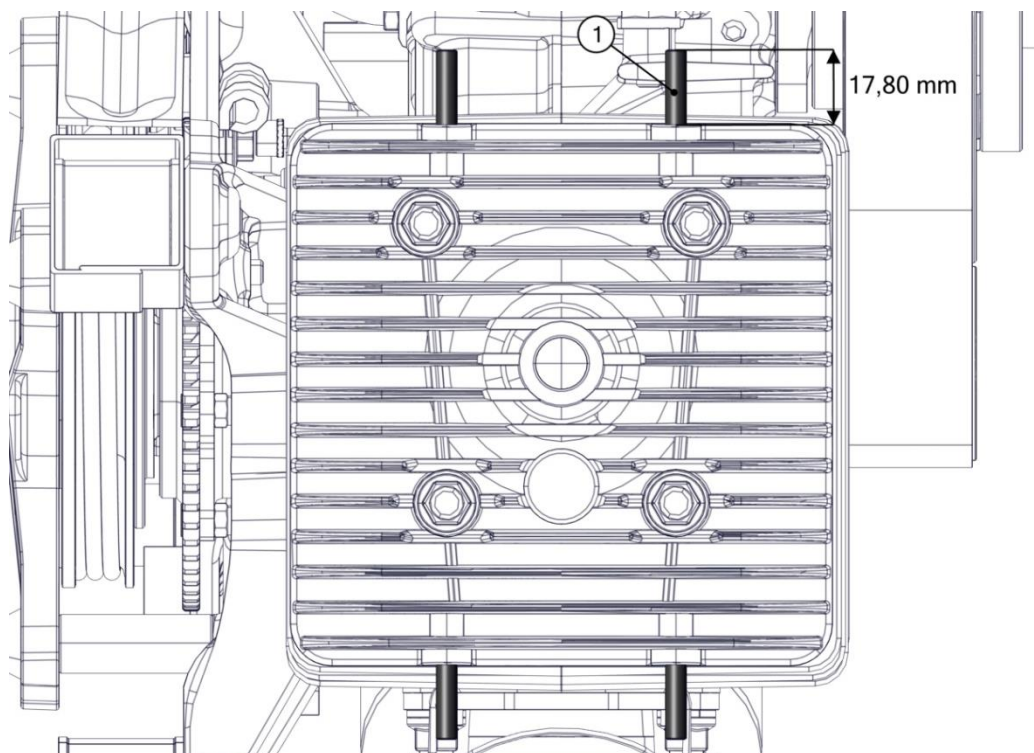

Insert the 4 internal metal washers (2) and then, the 6 internal rubbers (3) as shown in the figure.

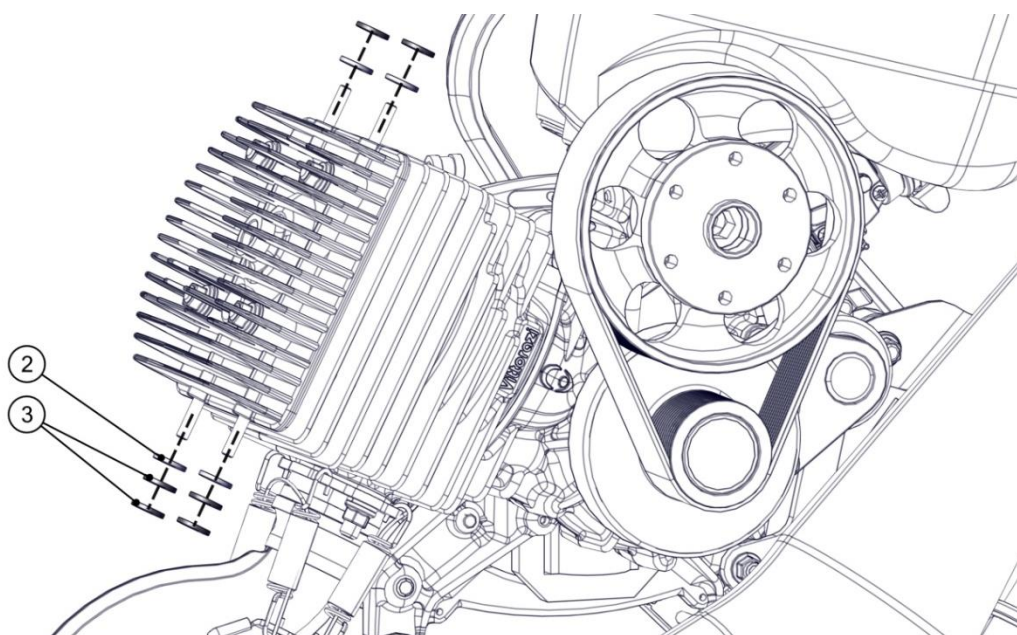

Place the cooling shroud (4) on the airbox side as shown in the figure.

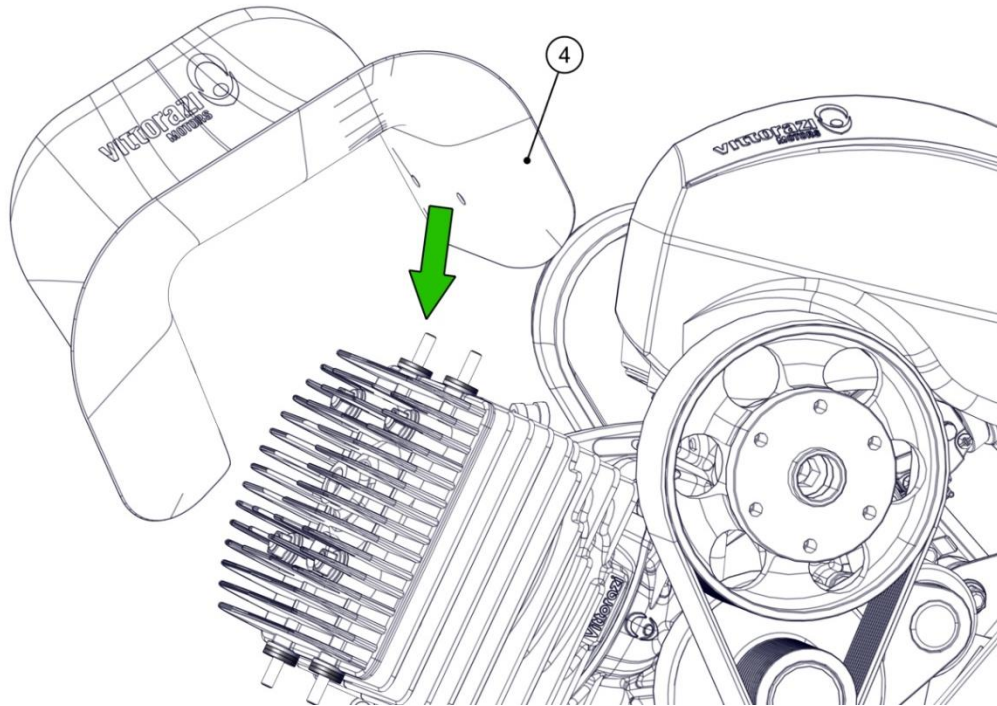

Assembly requires bending the cooling shroud (4), so gloves must be used and force applied. The carbon layer is flexible and will not be damaged during assembly bending.

Pass the cooling shroud (4) over the two M5x30 studs (1) and then insert the M5x30 studs (1) into the holes provided.

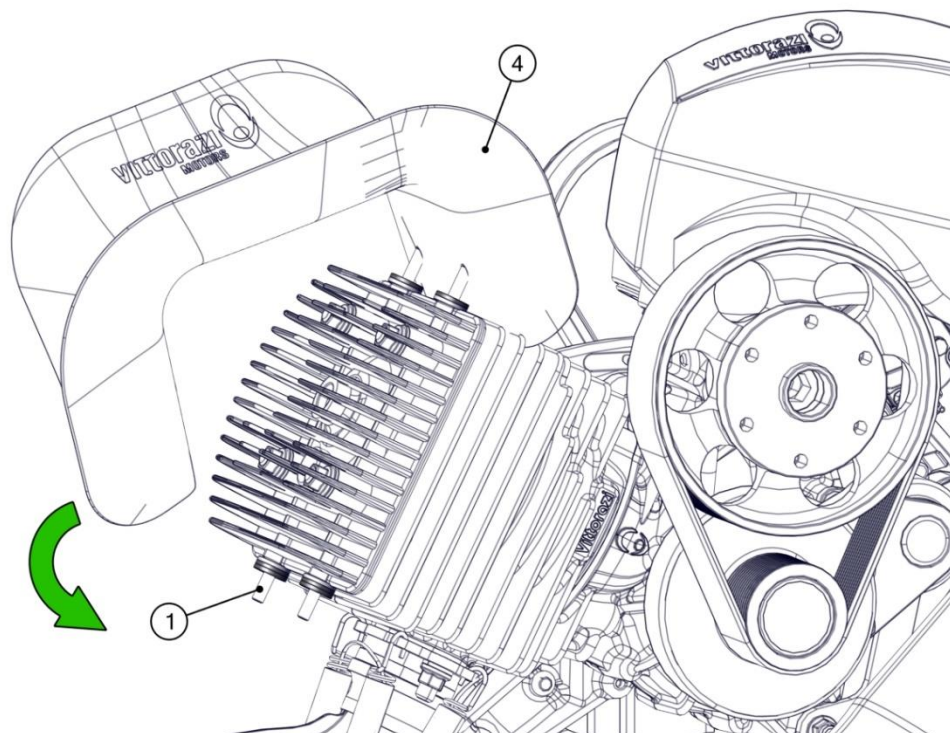

Insert the sparkplug and tighten with the torque shown in the figure.

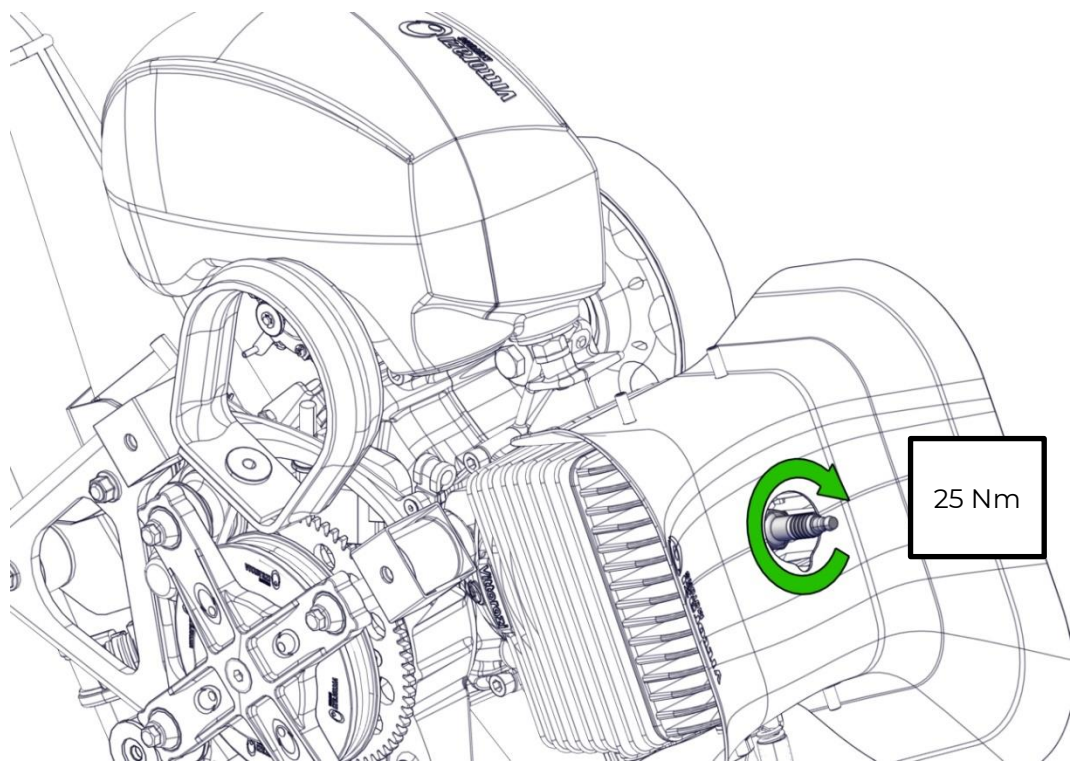

Insert the sparkplug seal (5) on the sparkplug cap (6).



Insert the sparkplug cap (6) on the sparkplug.

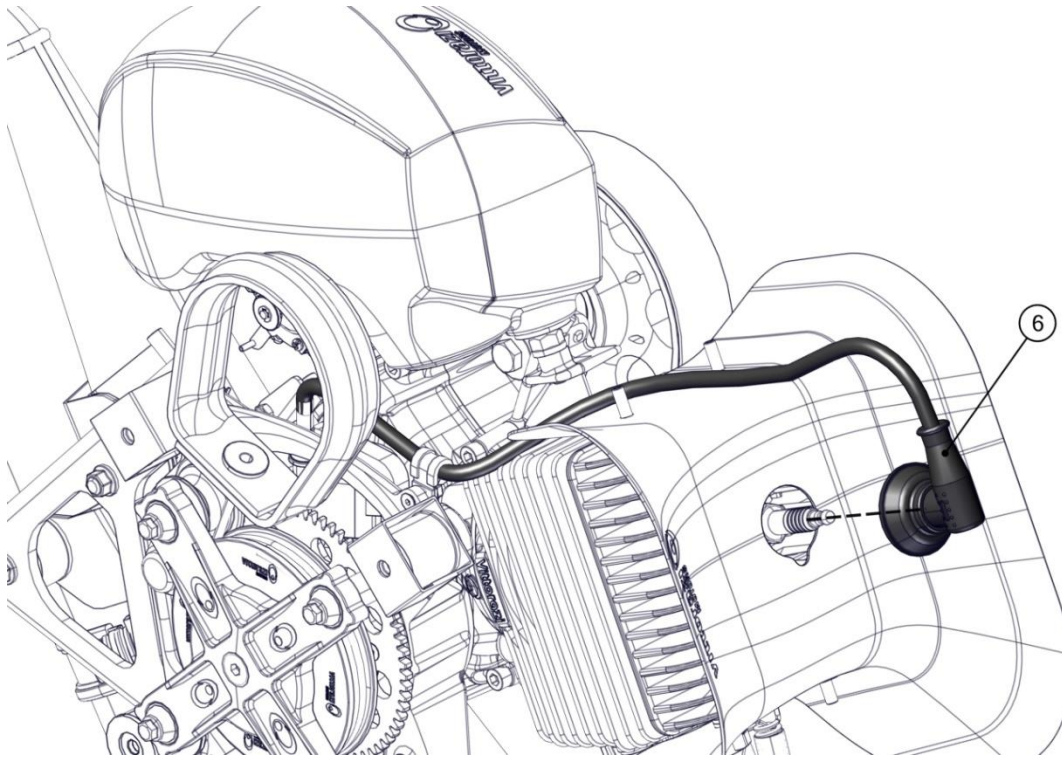

Secure the exhaust side of the cooling shroud (4) by inserting the 2 external rubbers (7), the 2 external washers (8) and the 2 self-locking nuts M5 (9). Bring the nuts (9) into contact with the washers (8) and tighten by an additional 2 turns.

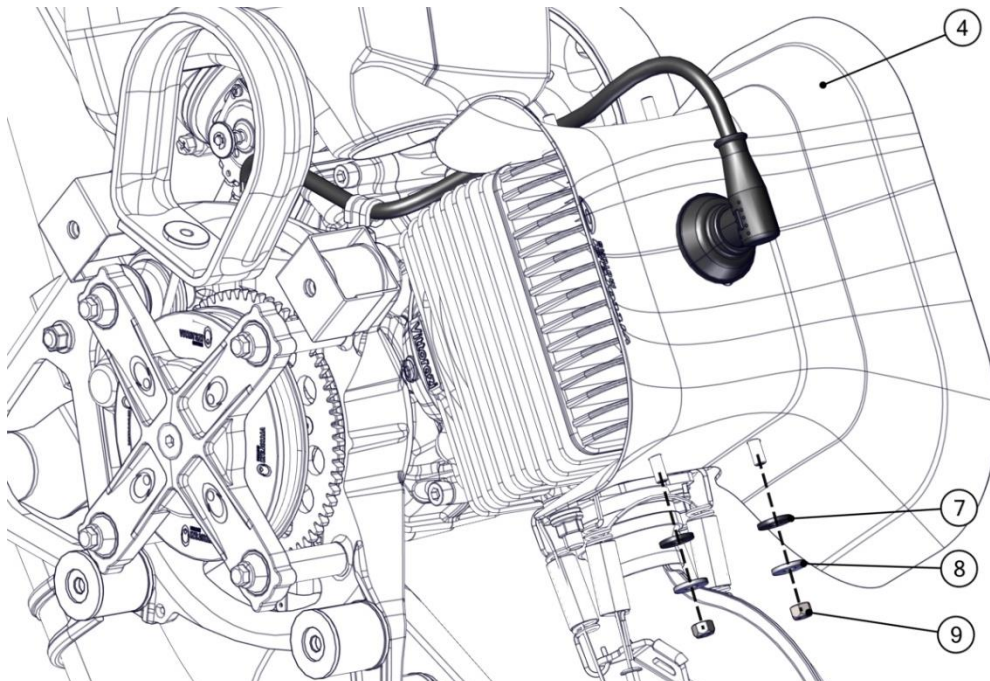

Secure the airbox side of the cooling shroud (4) by inserting the 2 external rubbers (10), the 2 external washers (11), secure the sparkplug cable (12) with the M5 F8 cable clamp (13) and insert the 2 self-locking nuts M5 (14) as shown in the figure. Bring the nuts (14) into contact with the washers (11) and tighten by an additional 1,5 turns.

